

# FINE CONTROLS (UK) LTD



Fine Controls have been supplying process controls & instrumentation equipment since 1994, & now serves an ever expanding customer base, both in the UK & globally.

We offer a full range of valve & instrumentation products & services, with our product range representing leading technologies & brands:

**Flow:** Flow Meters & Transmitters, Flow Switches, Flow Control Valves & Batch Control Systems

**Temperature:** Temperature Probes & Thermowells, Temperature transmitters, Temperature Regulators & Temperature Displays

**Level:** Level Transmitters & Switches

**Pressure:** Pressure Gauges & Transmitters, Precision & High Pressure Regulators & I-P Converters, Volume boosters.

**Precision Pneumatics:** Pressure Regulators, I-P Converters, Volume Boosters, Vacuum Regulators

**Valves:** Solenoid & Pneumatic Valves, Control Valves & Positioners, Actuated Ball, Globe or Diaphragm Valves & Isolation Valves

**Services:** Repair, Calibration, Panel Build, System Design & Commissioning

A rotork® Brand  
**FAIRCHILD**



**bürkert**



**SIEMENS**



**alcon**  
SOLENOID VALVES

A rotork® Brand



**MIDLAND-ACS**  
A rotork® Brand



**Honeywell**



**Bourdon**  
Baumer Group



**SOLDO**  
CONTROLS

A rotork® Brand



Fine Controls (UK) LTD, Bassendale Road, Croft Business Park,  
Bromborough, Wirral, CH62 3QL UK  
Tel: 0151 343 9966  
Email: sales@finecontrols.com

## 1600 SERIES MANUALLY OPERATED (LEVER)



- Specifically designed for Severe Offshore Environments

- Compact

- Closed Center

- NACE standard on application

- Stainless steel internals

### General Description

A range of compact 3/2 pilot operated spool valves in Stainless Steel for use on gases and liquids.

### Working Temperature Range

- -20°C to +180°C (-4°F to +356°F)

### Maximum Flow

- 6 bar (87 psi),  
1 bar (14.5 psi) differential
- 3/2 valves - 3500 L/min (123 SCFM)
- 5/2 valves - 3500 L/min (123 SCFM)

### Operating Medium

- Gases - Filtered non-lubricated air, inert, sweet (natural) gases
- Liquids - Low pressure hydraulic, mineral oil or water

### Ports NPT (BSP option available)

- 1/2" NPT
- 1/8" NPT vent port

### Working Pressure (gases & liquids)

- 12 bar (174 psi) Maximum

### Operating Force

- At 10 bar (145psi) body pressure

3/2	61N (13.7 lbf)
5/2	61N (13.7 lbf)

### Cv (Kv)

- 3/2 valves - 3.5 (53)
- 5/2 valves - 3.5 (53)

## 1600 SERIES MANUALLY OPERATED (LEVER)

**Note:**

- All dimensions given in mm

**Construction Materials**

- Body: 316 Stainless Steel
- Spool: 316 Stainless Steel
- Spring: 316 Stainless Steel
- Seals: Fluoroelastomer

Lever Operated, Spring Return

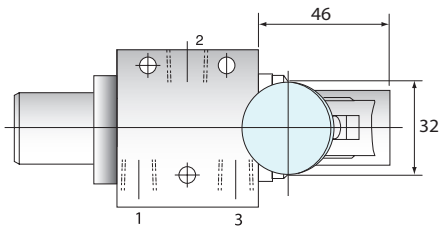

Lever Operated with Detent

